

Storage compartments/covers

Removing and installing glove compartment

- Unclip dash panel cover.
- Unplug connector -4- for glove compartment light.
- Unscrew bolts -1- (4x).
- Unscrew bolt -2-.
- Open glove compartment lid; Unscrew bolts -3- (3x).
- Move securing plate aside approx. 1 cm in direction of arrow and release catch.
- Unplug connector to passenger airbag key switch => Fig.1
- Remove passenger airbag deactivation switch => Page [69-97](#)

- Remove glove compartment.

1. **Bolts (4x)**
 - Tightening torque 4 Nm
2. **Bolt (1x)**
 - Tightening torque 4 Nm
3. **Bolts (3x)**
 - Tightening torque 4 Nm
4. **Connector**
5. **Mounting plate**

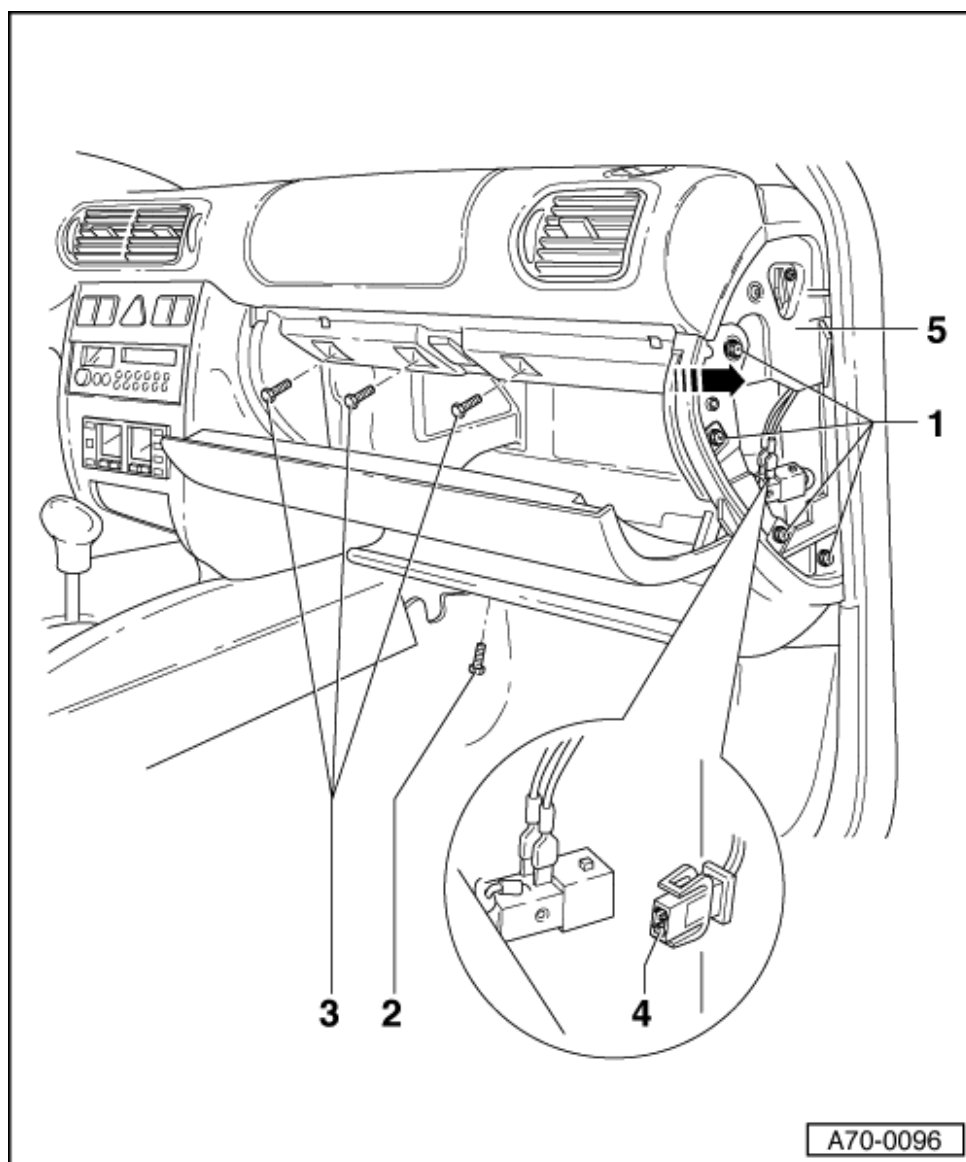

Fig.1 Detaching connector for passenger airbag key switch.

- Press release -3- and remove plug -2- from switch -1-.

